

HORSE SCHEDULE

Horse Committee: Jane Mitchell; Chairman, Kim Bilton; Deputy

Beverley Girling; Stan Fear; Leanne Graham; Gladys Grentell; Paul O'Hagan; Peter O'Hagan; Graeme Marriott; Jack Rae OAM; James Connard; Cathy Bashford; Gayle Joyce, Matt Burns, Peter Strafford, Rhonnda Strafford.

THE HORSE COMMITTEE WISH TO ACKNOWLEDGE AND THANK THE FOLLOWING VOLUNTEERS FOR THEIR EFFORTS

Horse Secretary: Jane Stuchbery

Horse Ring Stewards including, but not exclusive of: D. Akister, D. Allen, L. Allen, M. Allen, C. Betts, M. Bilton, M. Bourke, B. Byron, L. Cassar, F. Corry, B. Croke, D. Dell, A. Duggan, E. Griffiths, W. Guy, M. Hewitt, J. Kelly, F. Kompe, L. Lee, W. Loughnan, R. Loughnan, E. Mitchell, R. Morgan, J. Morgan, D. Nosedá, J. Pike, C. Pulis, M. Reedy, K. Reedy, E. Reedy, S. Thomson, S. Wakelam, A. Whitelaw, A. Wilson, D. Chapman, B. Ker, E. Ker.

While compiling this schedule, the society has noted the policies, rules and regulations which at this time are in force within the state of Victoria, regarding animal welfare, trade practices, anti-discrimination, competition policies and risk management.

ALL LIVESTOCK ENTRY/EXIT SINCLAIR ROAD – SHOWGROUND GATES OPEN 6.30AM BOTH DAYS

- > **STABLES:** Sorry no stabling is available.
 - > **CAMPING:** Anyone setting up overnight must camp where instructed by Committee or Stewards and definitely inside fenced areas.
 - > **All stallions are to be double tied to floats/trucks.**
 - > **APPROVED HELMETS MUST BE WORN WHILST MOUNTED.**
 - > **Exhibitors whilst at the show, work within the occupational health and safety legislation of the state of Victoria.**
 - > **Novice** means never to have won a similar class competing singularly at an affiliated agricultural show.
 - > **Open** means open to any horse that fits the height/age requirements of the class.
 - > **Champions** champion open saddle horses may not compete in show hunter classes. Once a horse has achieved a champion then it cannot compete in a similar class.
 - > **First season/newcomers** these events are open to horses who are eligible to compete in both VAS Ltd first season classes and Barastoc Newcomer classes. Horses are not eligible if previously shown under saddle prior to 1 January (first season) or 1st May (newcomer) of the current calendar year. Horses may only compete in these classes for one season at the beginning of their saddle career, open hacks are ineligible.
-

RULES

ENTRIES CLOSE: 31st October, 2015

ENTRY FEE PER CLASS: \$4.00 (Unless otherwise stated)

LATE ENTRY ON DAY: Double entry fee

*TFO = To Follow On (as this Society does not know how long classes will run, please be available from the commencement time of your ring)

LUNCH BREAK TAKEN IN ALL RINGS BETWEEN 12 NOON AND 1.00 PM (EXCLUDING SHOW JUMPING & LIGHT HARNESS)

MAIN ARENA

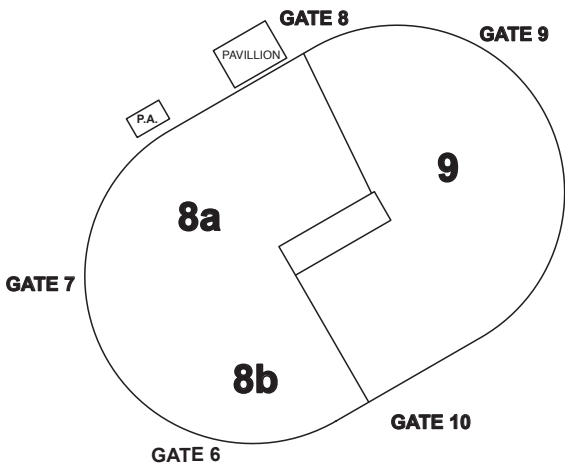

SOUTH ARENA

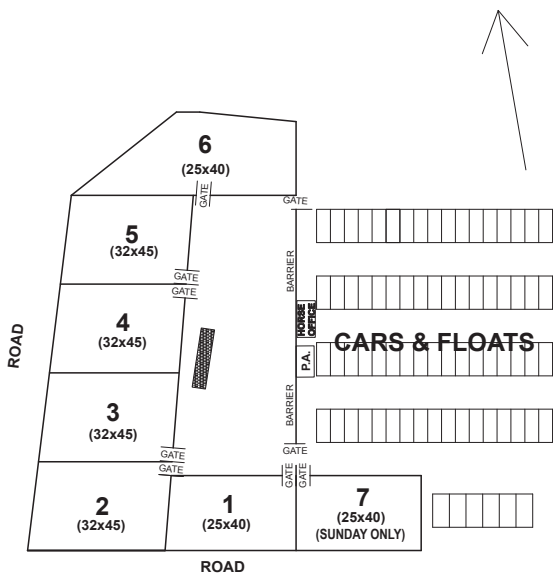

HORSE PROGRAM INDEX

SATURDAY

All events (excepting Clydesdale, Light Harness, & Showjumping) on South Arena.

EVENT	SECTION	RING	TIME
Welsh	ASA	1	9am
Small Shetland Pony 8.2h & under	BSA	2	9am
Shetlands	CSA	2	TFO*
Australian Ponies (APSB)	DSA	3	9am
APSB Riding Pony & Part Bred	ESA	3	TFO*
APSB Moorland & Fjord Horses	FSA	3	TFO*
Gypsy Cob	GSA	3	TFO*
Australian Stockhorse	HSA	4	9am
Open Led/Ridden Ponies	ISA	4	11am
Open Coloured	JSA	4	1pm
Adult Riding HRCAV	KSA	5	9am
Friesian Horses	LSA	6	9am
Andalusian Horses	MSA	6	TFO*
Miniature Ponies	NSA	6	1pm
Clydesdales	OSA	8a	9am
Clydesdale Cross Sport Horse	PSA	8a	TFO*
Light Harness	QSA	8b	12noon

SUNDAY

All events (excepting Sporting Horse & Showjumping) on South Arena.

EVENT	SECTION	RING	TIME
Newcomers/ Smartest on Parade/Riding	ASU	1	9.00am
Riding Pony	BSU	1	TFO*
Saddle Horse Championship Event	CSHSU	2&3	8.30am
Show Hunter-Pony/Galloway/Hack	CSU	2	10am
Show Hunter-Galloway/Hack/Pony	DSU	3	10am
Standard bred Horse	ESU	4	8.30am
Show Hunter-Hack/Pony/Galloway	FSU	4	10am
Pinto	GSU	5	9am
Palomino	HSU	5	11am
Buckskin	ISU	5	1pm
Arabians & Derivatives	JSU	6	9am
Open Coloured	KSU	6	TFO*
Sporting Horse	LSU	8	10am

SHOW JUMPING	SECTION	RING	TIME
Show jumping - Saturday	SJ	9	8.30am
Show jumping - Sunday	SJ	9	8.30am

SATURDAY PROGRAM

SECTION ASA

WELSH

SOUTH ARENA: RING NO.1

Judged: Saturday at 9.00am

Judge: Jane Gerber

(Information page 32)

- > All Exhibitors must be registered with the Welsh section of the APSB or the WPCS Aust. Inc. Exhibitors must be financial members of the APSB or WPCS Aust. Inc. and registration numbers must be entered on the entry form.

SPONSORED BY
GIPPSLAND & PENINSULA RPG-WPCS; TOORAVALE WELSH PONIES
LLANFAIRBRYN STUD



SECTION A

- 1 Best Presented Welsh
 - 2 Mare 4 years & over
 - 3 Filly 3 years
 - 4 Filly, 2 years
 - 5 Filly, yearling
 - 6 **Champion & Reserve Champion A Mare or Filly**
 - 7 Stallion 4 years & over
 - 8 Colt 3 years
 - 9 Colt 2 years
 - 10 Colt, yearling
 - 11 **Champion & Reserve Section A Stallion or Colt**
-

SECTION B

- 12 Mare 4 years & over
 - 13 Filly 3 years
 - 14 Filly 2 years
 - 15 Filly, yearling
 - 16 **Champion & Reserve Section B Mare or Filly**
 - 17 Stallion 4 years & over
 - 18 Colt 3 years
 - 19 Colt 2 years
 - 20 Colt, yearling
 - 21 **Champion & Reserve Section B Stallion or Colt**
-

SECTION C

- 22 Mare 4 years & over
 - 23 Filly 3 years & under
 - 24 **Champion & Reserve Section C Mare or Filly**
 - 25 Stallion 4 years & over
 - 26 Colt 3 years & under
 - 27 **Champion & Reserve Section C Stallion or Colt**
-

SECTION D

- 28 Mare 4 years & over
 - 29 Filly 3 years & under
 - 30 **Champion & Reserve Section D Mare or Filly**
 - 31 Stallion 4 years & over
 - 32 Colt 3 years & under
 - 33 **Champion & Reserve Section D Stallion or Colt**
-

SECTION E

- 34 Gelding of A breeding 4 yrs and over
 - 35 Gelding of B breeding 4 yrs and over
 - 36 Gelding of C breeding 4 yrs and over
 - 37 Gelding of D breeding 4 years & over
 - 38 **Champion & Reserve Senior Gelding**
 - 39 Gelding 3 years old
 - 40 Gelding 2 years old
 - 41 Gelding yearling
 - 42 **Champion & Reserve Junior Gelding**
 - 43 **SUPREME WELSH EXHIBIT – Perpetual Trophy donated by Llanfairbryn Stud**
(Part Welsh not eligible) plus Equinade Product
PART WELSH (Exhibits must be Registered with the WP & CS Aust. Inc. & Exhibitors
financial Members of the WP & CS Aust. Inc.)
 - 44 Led Gelding
 - 45 Led Filly 3 years and under
 - 46 Led Mare 4 years and over
 - 47 Led Colt 3 years and under
 - 48 Led Stallion 4 years and over
 - 49 **Champion & Reserve Part Welsh**
-

RIDDEN WELSH

- 50 Ridden Purebred Mare or Filly
- 51 Ridden Purebred Gelding
- 52 Ridden Purebred Stallion or Colt
- 53 **Champion & Reserve Ridden Welsh**

VETERINARY SERVICES

Exhibitors who exhibit large animals, are advised that whilst every effort is made to have a Veterinary Surgeon on the Showgrounds, this cannot be guaranteed. The purpose of this presence is to administer first aid or on the spot advice when a problem occurs, Should the Exhibitor's animal require further Veterinary treatment, then the cost of such treatment must be met by the owner of the exhibit.

SECTION BSA

SMALL SHETLAND PONIES

SOUTH ARENA Ring No.2
Judged: Saturday at 9am
Judge: Rebecca Gerber
(Information page 32)

> All Ponies in this section must be registered in the Shetland section of the Australian Pony Stud Book, and their registration number must be entered on the entry form.

- 54 Best Presented Small Shetland ne 8.2hh
- 55 Stallion 4 years & over ne 8.2hh
- 56 Colt 2 & 3 years, ne 8.2hh
- 57 **Champion & Res. Champion Stallion/Colt n/e 8.2hh**
- 58 Mare 4 years & over, ne 8.2hh
- 59 Filly 2 & 3 years ne 8.2hh
- 60 **Champion & Reserve Champion Mare/Filly n/e 8.2hh**
- 61 Yearling Colt/Gelding ne 8.2hh
- 62 Yearling Filly ne 8.2hh
- 63 **Champion & Reserve Champion Yearling, n/e 8.2hh**
- 64 Gelding 4 years & over ne 8.2hh
- 65 Gelding 2 & 3 years & under ne 8.2hh
- 66 **Champion & Reserve Champion Gelding, n/e 8.2hh**
- 67 **SUPREME CHAMPION SHETLAND n/e 8.2hh. Garland donated by Small Shetland Ponies 8.2hh & Under APSB Promotional Group**

SPONSORED BY :
SMALL SHETLAND PONIES 8.2HH & UNDER
(A.P.S.B. PROMOTIONAL GROUP)

SECTION CSA

SHETLAND PONY

SOUTH ARENA Ring No.2
Judged: Saturday to follow on after Small Shetland Ponies
Judge: Rebecca Gerber
(Information page 32)

> All Ponies in this section must be registered in the Shetland section of the Australian Pony Stud book, and their registration number must be entered on the entry form.

- 68 **Best Presented Shetland**
- 69 Stallion, 4 years & over, over 8.2 hh & not over 9.2 hh
- 70 Stallion, 4 years & over, over 9.2hh & not over 10.2 hh
- 71 **Champion & Reserve Champion Stallion**
- 72 Colt, 3 years
- 73 Colt, 2 years
- 74 Colt, yearling
- 75 **Junior Champion & Reserve Junior Champion Colt**
- 76 Miniature Turnout, Rider 6 years and under, must be led
- 77 Miniature Turnout, Rider over 6 and under 11 years
- 78 Junior Handler, 6 years & under
- 79 Junior Handler, 7 years & under 10 years
- 80 Junior Handler, 10 years & under 15 years

Junior Handler classes and ribbons to 6th place

The logo for Facey industrial • commercial, featuring a stylized 'F' icon followed by the word 'Facey' in a large, bold, sans-serif font, with 'industrial • commercial' in a smaller font below it.

6 Clow Street, Dandenong 3175
0418 322 443/9793 4455
faceyinternational.com.au

LICENSED ESTATE AGENTS

- 81 Foal, Colt or Filly
 82 Mare, 4 yrs & over, over 8.2hh & not over 9.2hh
 83 Mare, 4 yrs & over, over 9.2 hh & not over 10.2hh
 84 **Champion & Reserve Champion Mare**
 85 Filly, 3 years
 86 Filly, 2 years
 87 Filly, yearling
 88 **Junior Champion & Reserve Junior Champion Filly**
 89 Gelding, 9.2 hands & under, over 3 years
 90 Gelding, over 9.2 hands, over 3 years
 91 Gelding, under 3 years
 92 **Champion & Reserve Champion Gelding**
-
- 93 **SUPREME CHAMPION SHETLAND PONY** (Geldings eligible) – Rosette plus **Equinade Product**
-
- 94 Broken Coloured Shetland Pony Male
 95 Broken Coloured Shetland Pony Female
 96 **Best Coloured Shetland Pony**
 97 Shetland Group, Stallion or Colt & 2 Females, any age owned but not necessarily bred by the Exhibitor
 98 Two Shetlands, Mares or Fillies, owned by the exhibitor
 99 Novice Ridden Shetland Mare or Gelding
 100 Ridden Shetland Stallion
 101 Ridden Shetland Mare
 102 Ridden Shetland Gelding
 103 **Champion & Reserve Champion Ridden Shetland**
 104 Shetland, in harness
 105 Fancy Dress, (Entires not eligible)

SECTION DSA

AUSTRALIAN PONY

SOUTH ARENA Ring No.3
 Judged: Saturday at 9.00am
 Judge: Penny Johnson
(Information page 32)

- > All Ponies competing in this Section must be registered in the Australian Pony Section of the APSB Society Inc. Exhibitors must be current financial members of the APSB Society Inc.

QUALIFYING SHOW FOR APSB PONY OF THE YEAR AWARD

- 106 **Best Presented Australian Pony**
 107 Stallion, 4 years & over, 14hh & under
 108 Colt, 2 & 3 years
 109 Yearling Colt
 110 **Champion and Reserve Champion Australian Pony Stallion or Colt**
\$10 donated by APOB for Champion
 111 Dry Mare, 4 years & over, over 12 hh & not over 14 hh
 112 Dry Mare, 4 years & over, 12 hands & under
 113 **Champion & Reserve Champion Australian Pony Mare**
\$10 donated by APOB for Champion
 114 Filly, 2 & 3 years, over 12 hh & not over 14 hh
 115 Filly, 2 & 3 years, 12 hh & under
 116 Yearling Filly
 117 **Champion & Reserve Champion Australian Pony Filly.**
\$10 donated by APOB for Champion
 118 Gelding, 4 years & over, not over 14hh
 119 Gelding, 3 years & under
 120 **Champion & Reserve Champion Australian Pony Gelding**
\$10 donated by APOB for Champion
 121 **SUPREME CHAMPION AUSTRALIAN PONY**
\$100 donated by Storm Haven and Equinade Product

RIDDEN CLASSES

- 122 Ridden Saddle Stallion, Colt or Gelding not over 14hh
 123 Ridden Saddle Mare or Filly not over 14hh
 124 **Champion & Reserve Champion Ridden Australian Pony**
\$10 donated by APOB for Champion
 125 Ridden Show Hunter Pony not over 12.2hh
 126 Ridden Show Hunter Pony over 12.2hh & not over 14hh
 127 **Champion & Reserve Champion Ridden Show Hunter Pony**
\$10 donated by APOB for Champion

PROUDLY SPONSORED BY:
APSB VICTORIAN BRANCH,
AUSTRALIAN PONY OWNERS & BREEDERS
MOOROODUC PARK AUSTRALIAN PONIES
STORM HAVEN AUSTRALIAN PONIES



SECTION ESA

APSB RIDING PONY & APSB PART BRED

SOUTH ARENA Ring No.3

Judged: Saturday to follow on after Australian Ponies

Judge: Penny Johnson

(Information page 32)

- > All Ponies competing in this Section must be recorded in the APSB.
- > Riding Pony or APSB Part Bred Pony Section of the APSB Society Inc.
- > Exhibitors must be current financial members of the APSB Society Inc.

- 128 **Best Presented APSB Riding Pony or Part Bred**
- 129 APSB Riding Pony Stallion, Colt or Gelding n/e 14.2h
- 130 APSB Riding Pony Mare n/e 14.2h
- 130a APSB Riding pony filly or gelding under 3 years
- 131 APSB Part Bred Male or Female over 4 years
- 131a APSB Part bred filly/gelding under 3 years
- 132 **Champion & Res. Champion APSB Riding Pony/APSB Part Bred Exhibit**
- 133 Ridden APSB Riding Pony
- 134 Ridden APSB Part Bred Pony
- 135 **Champion & Res. Champion Ridden APSB Riding Pony/APSB Part Bred Exhibit**

PROUDLY SPONSORED BY:

THE APSB VICTORIAN BRANCH AND GIPPSLAND REGIONAL APSB PROMOTIONAL GROUP.

All Ponies competing in this Section must be recorded in the APSB Riding Pony or APSB Part Bred Pony Section of the APSB Society Inc.

SECTION FSA

APSB MOORLAND PONIES & FJORD HORSE

SOUTH ARENA Ring No.3

Judged: Saturday to follow on after APSB Riding Pony & Part Bred

Judge: Penny Johnson

(Information page 32)

THIS SECTION IS PROUDLY SPONSORED BY
APSB VICTORIAN BRANCH

- > Eligible Breeds: Connemara, New Forest, Dartmoor, Highland & Fjord Horse. All ponies competing in this section must be recorded in their respective breed section of the APSB Society Inc. Exhibitors must be current financial members of the APSB Society Inc.

- 136 **Best Presented Moorland or Fjord**
- 137 Stallion, Colt or Gelding Led
- 138 Mare or Filly Led
- 139 **Champion & Res. Champion APSB Moorland/Fjord Horse Exhibit**
- 140 Ridden Pony from above classes

SECTION GSA

GYPSY COB SECTION

SOUTH ARENA Ring No.3

Judged: Saturday to follow on after APSB Moorland/Fjord Horse

Judge: Penny Johnson

(Information page 32)

- > All ponies competing in this section must be registered with a recognised Gypsy Cob Society.
- Champion, Reserve Champion & Supreme Sashes kindly donated by Watermark Gypsy Cobs.

PUREBRED GYPSY COB

- 141 **Best Presented Gypsy Cob**
- 142 Gypsy Cob Stallion, 4 & over
- 143 Gypsy Cob Colt, 3 & under
- 144 **Champion & Res. Champion Gypsy Cob Stallion/Colt**
- 145 Gypsy Cob Mare, 4 & over
- 146 Gypsy Cob Filly, 3 & under
- 147 **Champion & Res. Champion Gypsy Cob Mare/Filly**
- 148 **Supreme Champion Purebred Gypsy Cob – Garland kindly donated by Watermark Gypsy Cobs**
- 149 Gypsy Cob Ridden 3 years and over

PART BRED GYPSY COB

- 150 Gypsy Cob Part Bred Stallion
- 151 Gypsy Cob Part Bred Mare
- 152 Gypsy Cob Part Bred Gelding
- 153 Gypsy Cob Part Bred male or female, under 3 years
- 154 **Champion & Res. Champion Part Bred Gypsy Cob Male**
- 155 **Champion & Res. Champion Part Bred Gypsy Cob Female**
- 156 **Supreme Gypsy Cob Part Bred – Garland kindly donated by Watermark Gypsy Cobs**
- 157 Gypsy Cob Part Bred Ridden, 3 years & over
- 158 Gypsy Cob Part Bred Male or Female driven in long reins

SECTION HSA

AUSTRALIAN STOCKHORSE

SOUTH ARENA Ring No.4

Judged: Saturday at 9.00am
Judge: Marney Neil
(Information page 32)
HI POINT SHOW

- > All classes open to all registered or foal recorded ASH. Registration Papers & Memberships to be produced on request. All horses entered in this section must be classified & registered, or foal recorded for horses 3 years and under, with The Australian Stock Horse Society and registration number entered on entry form.

RING PROUDLY SPONSORED BY WEST GIPPSLAND ASH BRANCH

- 159 Best Presented Australian Stockhorse
- 160 Led colt or gelding 3 years and under
- 161 Led Stallion, 4 years & over
- 162 Led Gelding, 4 years & over
- 163 **Champion and Reserve Champion Led ASH Male.**
- 164 Led Mare, 4 years & over
- 165 Led Filly, 3 years & under
- 166 **Champion & Reserve Champion Led ASH Female**
- 167 **SUPREME LED STOCKHORSE- Equinade Product**
- 168 ASHLA-Sash sponsored by Wattlewood ASH Stud – MUST be a financial member of ASHLA to compete
- 169 Novice Ridden
- 170 Ridden Stockhorse 3 years & under
- 171 Junior ridden (Rider under 18 years)
- 172 Ridden Stockhorse Stallion
- 173 Ridden Stockhorse Mare
- 174 Ridden Stockhorse Gelding
- 175 **Champion & Reserve Champion Ridden Stockhorse**
- 176 Novice Working Stockhorse
- 177 Working 3 years and under
- 178 Junior Working (Rider under 18 years)
- 179 Working Mare
- 180 Working Stallion
- 181 Working Gelding
- 182 **Champion & Reserve Champion Working Stockhorse**
- 183 Pleasure Horse
- 184 Station Horse

SECTION ISA

PONIES LED & RIDDEN – OPEN TO ALL BREEDS

SOUTH ARENA RING NO.4

Judged: Saturday not before 11.00am to follow on
Judge: Marney Neil
(Information page 32)

LED CLASSES

- 185 **Best Presented Pony**
- 186 Yearling Colt
- 187 Yearling Filly
- 188 Colt, 2 & 3 years old
- 189 Filly, 2 & 3 years old
- 190 **Junior Champion & Junior Reserve Champion – Champion sponsored by Horseland Narre Warren**
- 191 Mare, 12hh and under
- 192 Mare, over 12hh and not over 13hh
- 193 Mare, over 13hh and not over 14hh
- 194 Foal (not eligible for champion)
- 195 **Champion & Reserve Champion Mare – Champion sponsored by Horseland Narre Warren**
- 196 Gelding, 12hh and under



- 197 Gelding, over 12hh and not over 13hh
 198 Gelding, over 13hh and not over 14hh
 199 Stallion, 4 years and over
 200 **Champion & Reserve Champion Male – Champion sponsored by Horseland Narre Warren**
 201 **Supreme Led Pony – Rug sponsored by Horseland Narre Warren**

RIDDEN CLASSES

- 202 Ridden Stallion, 12hh and under
 203 Ridden Stallion, over 12hh and not over 14hh
 204 Ridden Gelding, 12hh and under
 205 Ridden Gelding, over 12hh and not over 14hh
 206 **Champion & Reserve Champion Ridden Male – Champion sponsored by Horseland Narre Warren**
 207 Ridden Mare, not over 12hh
 208 Ridden Mare, over 12hh and not over 13hh
 209 Ridden Mare, over 13hh and not over 14hh
 210 **Champion & Reserve Champion Ridden Female – Champion sponsored by Horseland Narre Warren**

SECTION JSA

OPEN COLOURED

SOUTH ARENA RING NO.4

Judged: Saturday – not before 1.00pm to follow on after Ponies Led & Ridden
 Judge: Marney Neil
(Information page 32)

> Open to all coloured Pinto, Paint, Spotted, Buckskin, Palomino, Perlino and White - registered or not.

- 211 **Best Presented Open Coloured**
 212 Led Stallion/Colt, 10.2 hands & under
 213 Led Stallion/Colt, 10.2 hands to under 12hh
 214 Led Stallion/Colt, 12.hh to 14hh
 215 Led Stallion/Colt, over 14 hands
 216 **Champion & Reserve Champion Stallion/Colt**
 217 Led Mare/Filly, 10.2 hands & under
 218 Led Mare/Filly, 10.2 hands to under 12hh
 219 Led Mare/Filly, 12.hh to 14hh
 220 Led Mare/Filly, over 14 hands
 221 **Champion & Reserve Champion Mare/Filly**
 222 Led Gelding, 10.2 hands & under
 223 Led Gelding, 10.2 hands to under 12hh
 224 Led Gelding, 12.hh to 14hh
 225 Led Gelding, over 14 hands
 226 **Champion & Reserve Champion Gelding**
 227 Ridden, 10.2 hands & under
 228 Ridden, 10.2 hands to under 12hh
 229 Ridden, 12.hh to 14hh
 230 Ridden, over 14 hands
 231 **Champion & Reserve Champion Ridden Exhibit**
 232 Costume Class, under 14 hands
 233 Costume Class, over 14 hands

SECTION KSA

HRC AV CLASSES

SOUTH ARENA RING NO.5

Judged: Saturday at 9.00 am
 Judge: Georgia Aikman
(Information page 32)
 Host Club: Merlinvale ARC –
 Enquiries: Carole Zimmari 9436 4720 OR Lindy Knell 9716 3044
 Card Secretary: Paul Knell

> This ring is conducted under HRC AV Rules for members of Clubs affiliated with the HRC AV. Performance AND membership cards to be presented to CARD SECRETARY by 8.30am. Stallions permitted with ID. Riders must supply own competitor numbers – numbers to be displayed on both sides of horse or on a breast plate. Medical armbands required for classes involving jumping.
 (*) denotes points earning classes for HIGH POINT AWARD – winner receives Equinade Product.

PRIZES

- **SASHES TO 6TH PLACE FOR SMARTEST ON PARADE**
- **RIBBONS AWARDED TO 4TH PLACE.**
- **SASHES FOR CHAMPION/RESERVE.**

- 234 Smartest on Parade, levels 4 & 5*
 235 Smartest on Parade, levels 3*

- 236 Smartest on Parade, level 1 & 2*
- 237 Led Exhibit, 14.2 hh & under
- 238 Led Exhibit, over 14.2 – 15.2 hh
- 239 Led Exhibit, over 15.2 hh
- 240 **Champion & Reserve Champion Led HRCav exhibit**
- 241 HRCav Rider, levels 4 & 5*
- 242 HRCav Rider, level 3*
- 243 HRCav Rider, levels 2 & 1*
- 244 **Champion & Reserve Champion HRCav Rider ***
- 245 Ridden HRCav Exhibit, levels 4 & 5*
- 246 Ridden HRCav Exhibit, level 3*
- 247 Ridden HRCav Exhibit, levels 1 & 2*
- 248 **Champion & Reserve Champion Ridden HRCav Exhibit***
- 249 Mount most Suitable for Beginner, level 4 & 5
- 250 Best Educated Mount, level 1, 2 & 3
- 251 Mount most Suitable for Horse Trials level 1, 2 & 3
- 252 Mount most Suitable for Horse Trials level 4 & 5
- 253 Mount most suitable for HRCav levels 1 & 2 (required to jump)*
- 254 Mount most suitable for HRCav level 3 (required to jump)*
- 255 Mount most suitable for HRCav levels 4 & 5 (required to jump)*
- 256 **Champion & Reserve Champion Mount most suitable for HRCav**

SECTION LSA

FRIESIAN HORSES

SOUTH ARENA RING NO. 6

Judged: Saturday 9.00am
 Judge: Kyle Baboth
(Information page 32)

- > Horse must be registered with a recognized breed society.
- Proudly sponsored by Grove Born Friesian Horses & AFWHS.

- 257 Best Presented, pure bred Friesian
- 258 Led pure bred male – colts, geldings, stallions
- 259 Led pure bred female
- 260 **Champion & Reserve Champion Led Pure Bred Friesian**
- 260a Best Presented part bred Friesian
- 261 Led part bred male – colts, geldings, stallions
- 262 Led part bred female
- 263 **Champion & Reserve Champion Led Part Bred Friesian**
- 264 Ridden pure bred Friesian
- 265 Ridden part bred Friesian
- 266 **Champion & Reserve Champion Ridden Friesian**

SECTION MSA

ANDALUSIAN HORSES

SOUTH ARENA RING NO. 6

Judged: Saturday, to follow on after Friesians
 Judge: to be advised
(Information page 32)

- > Andalusians must be registered and the owners must be financial members of AHAA.
- Proudly sponsored by AHAA.

- 267 Best Presented, open to pure & part bred Andalusians
- 268 Led pure bred stallion/colt
- 269 Led pure bred mare/filly
- 270 Led Purebred gelding
- 271 **Champion & Reserve Champion Led Pure Bred**
- 272 Led part bred filly/mare
- 273 Led part bred gelding
- 274 **Champion & Reserve Champion Led Part Bred**
- 275 Ridden pure bred male Andalusian
- 276 Ridden pure bred female Andalusian
- 277 **Champion & Reserve Champion Ridden Pure Bred**
- 278 Ridden part bred male Andalusian
- 279 Ridden part bred female Andalusian
- 280 **Champion & Reserve Champion Ridden Part Bred**
- 281 Open costume class – fiesta, traditional attire and baroque either ridden or in hand

Trophy for judges choice of Best Andalusian Exhibit of the show donated by El Shanador Park

HASTINGS MOWERS

2013 Frankston-Flinders Road, Hastings 3915

Telephone: 5979 1382 / Fax: 5979 3604

www.hasmow.com.au

SECTION NSA

AUSTRALIAN MINIATURE PONIES

SOUTH ARENA RING NO.6

Judged: Saturday not before 1.00 pm to follow on after Andalusian Horses

Judge: Kyle Baboth
(Information page 32)

- > All Ponies must be registered with The Australian Miniature Society and must not exceed 87 cms and registration numbers must be entered on the entry form. Sashes kindly donated by A & J Morgan.

- 282 **Best Presented Australian Miniature Pony**
- 283 Stallion. 6 years & over
- 284 Stallion. 4 years & five years
- 285 **Champion & Reserve Champion Stallion**
- 286 Colt. 3 years
- 287 Colt. 2 years
- 288 Colt. yearling
- 289 **Junior Champion & Reserve Junior Champion Colt**
- 290 Mare. 6 years & over
- 291 Mare. 4 and 5 years
- 292 Foal (Foal must be recorded)
- 293 **Champion & Reserve Champion Mare**
- 294 Filly, 3 years
- 295 Filly, 2 years
- 296 Filly, yearling
- 297 **Junior Champion & Reserve Junior Champion Filly**
- 298 Gelding, 4 years & over
- 299 Gelding, 2 and 3 years
- 300 Gelding, yearling
- 301 **Champion & Reserve Champion Gelding**
- 302 **Supreme Champion Miniature Pony – Equinade Product**
- 303 Child Handler. 6 years & under
- 304 Child Handler. 7 years to 11 years
- 305 Child Handler. 12 years to 17 years
- 306 Best Child Handler
- 307 Australian Miniature Pony Stallion or Gelding in Harness
- 308 Australian Miniature Pony Mare or Filly in Harness
- 309 **Champion Australian Miniature Pony in Harness**
- 310 Best Presented Australian Miniature Pony in Harness
- 311 Best Driver

SECTION OSA

CLYDESDALE FARM & DELIVERY

MAIN ARENA RING NO. 8 – ENTRY TO RING VIA GATE 7

Judged: Saturday at 9.00am.

Judge: t.b.a.
(Information page 32)

- > Exhibitors Please Note: all entries in classes marked * must be CCHS registered.
- > Clydesdale Parking available on Southern side of exhibition pavilion – close to Show Ring.
- > **NOTE:** Entries, which in the opinion of the Judge are incorrectly entered, will be moved to their correct class.
- > Most Successful Exhibitor is calculated: 1st = 3 points; 2nd = 2 points; 3rd = 1 point.



Saddleworld

A WORLD OF DIFFERENCE

The Tack Box Saddleworld
1544 Frankston-Flinders Road, Tyabb 3913
5977 3522
info@tackbox.com.au / tackbox.com.au

SADDLERY

DANDENONG AGRICULTURAL & PASTORAL SOCIETY WOULD LIKE TO ACKNOWLEDGE THE EFFORTS OF THE ORGANISING SUB-COMMITTEE FOR THE CLYDESDALE SECTION.

Messrs. L. Allen; G Marriott; I Marriott;

- 312 **Best Presented Clydesdale**
313 *Clydesdale Stallion, 3 years & over
314 **Champion & Reserve Champion Entire 3 years & over**
Champion trophy donated by: Peter Horobin Saddlery
315 *Clydesdale Colt, 2 year old
316 *Clydesdale Colt, yearling
317 **Junior Champion & Reserve Junior Champion Entire**
\$20 Champion prize money donated by: EJ Marriott
318 *Clydesdale Mare, visibly in foal, or with foal at foot
319 *Clydesdale Foal, haltered. Mare may accompany foal in ring
320 *Clydesdale Dry Mare, 3 years & over
321 **Champion & Reserve Champion Mare 3 years & over**
Champion-Tony Heitch Memorial Trophy donated by: Mrs. Heitch
322 *Clydesdale Filly, 2 years old
323 *Clydesdale Filly, yearling
324 **Junior Champion & Junior Reserve Champion Female**
\$50 Champion prize money donated by: Gardenworld & Southern Advanced Plants
325 **JUNIOR CHAMPION CLYDESDALE**
\$50 Prize money donated by: Gendore Tractor Machinery Sales & Service.
326 *Clydesdale Gelding, 3 years & over
327 *Clydesdale Gelding, 2 years & under
328 **\$30 Champion & Reserve Champion Gelding**
329 **SUPREME CHAMPION LED CLYDESDALE: Equinade Product**
\$50 and Reg Arnott Memorial Trophy and Perpetual Trophy kindly donated by:
Melbourne Markets. (This trophy is to be held by the Society)
330 *Best Male Handler over 16 years
331 *Best Female Handler over 16 years
332 *Junior Handler 12 - 16 years
333 *Junior Handler under 12 years
334 *Pair of Clydesdales, led, owned by Exhibitor
335 *Group of 3 Clydesdales, led, owned by Exhibitor
336 *Progeny Group, pair of Clydesdales, any age or sex, progeny of one sire or dam.
Nominate sire or dam
337 *Clydesdale Stallion or Mare and one progeny thereof. Foal ineligible
338 Novice Exhibitor – Award for exhibitor who has not won a prize at a regional show
Horse to be owned by exhibitor. \$25 Prize money donated by: **Leigh & Vanessa Allen**

HARNESS & DELIVERY CLASSES

- 339 Led utility Farm Horse Crossbred type, suitable to ride, drive & work in chains
340 Single Clydesdale Gelding, or registered shire, driven in collar & hames
341 Single Clydesdale Mare, or registered shire, driven in collar & hames. (If not enough entries in Mare class, both will combine as one class)
342 Lady Driver over 16 yrs, Horse to be driven in collar & hames
Prize money for Lady Driver donated by: **Marriott Contracting Group**
343 Junior Driver under 12 yrs, Horse to be driven in collar & hames
Prize money: 1st: \$10; 2nd \$5
344 Junior Driver 12-16 yrs, Horse to be driven in collar & hames.
Prize money: 1st \$10; 2nd \$5
345 Winners of Junior Driver classes will come together to be judged for:
The Shane Thomas Bourke Memorial Trophy kindly donated by: **Maggie Bourke**
\$40 Prize money for Most Successful Exhibitor Harness classes donated by:
Norm & Lyn Dennis
346 Male Shire Horse – led
347 Female Shire Horse – led
348 **CHAMPION SHIRE HORSE**

LUNCH BREAK

- 349 Light Delivery, 1 or more horses to be driven in vehicle
350 Medium Delivery, 1 or more horses to be driven in vehicle
351 Heavy Delivery, 1 or more horses to be driven in vehicle
NB – in the above 3 classes - Where more than one horse in vehicle, horse to be nominated. Prize money for Heavy Delivery Class – Andrew James Bourke Memorial Trophy for Heavy Delivery Horse. Donated by: **Maggie Bourke**
352 Junior Delivery Driver 9-13 years old (accompanied by an adult)
353 Junior Delivery Driver 14-17 years old
354 Novice Delivery Driver – must not have won a first prize at a show in a delivery class.
355 Tradesmen's or Business Turnout, 2 wheeled vehicle, harness & vehicle to be taken into consideration
356 Tradesmen's or Business Turnout, 4 wheeled vehicle, harness & vehicle to be taken into consideration
Note: Turnout classes to be judged on: Horse 60 points; Vehicle 25 points;
Harness 15 points
357 **Champion & Reserve Champion Tradesman's Turnout**
\$50 Champion prize money

- 358 **Champion & Reserve Champion Harness Horse**
\$50 Champion prize money donated by I & V Marriott
- 359 Open to all Clydesdales. Working Horse – Not Show Harness – not Show Vehicle or implement – \$40 sponsored by: **Geoff Marriott**
Stewards Award – sponsored by Mr & Mrs John ODonoghue
Most Successful Clydesdale Exhibitor – \$40 prize money
- 360 Ridden Clydesdale or registered shire
- 361 Strappers Award (Free entry) \$40 Prize money

SPONSORS & DONORS

THE CLYDESDALE COMMITTEE GRATEFULLY ACKNOWLEDGE AND WISH TO THANK THEIR SPONSORS AND DONORS:

Leigh & Vanessa Allen; Arnott Family; Maggie Bourke; Daisy Downs Garden Supplies; Norm & Lyn Dennis; Equimec Horse Paste; Equinade Horse Care Products; Garden City Plastics; Gardenworld & Southern Advanced Plants; Gendore Farm Machinery; Hastings Produce & Rural Supplies; Mrs. Ann Heitch & Family; Hickinbotham Winery; Peter Horobin Saddlery; Marriott Contracting Group; Mr & Mrs G & L Marriott; Mr Geoff Marriott; Mr & Mrs I & V Marriott; Mr & Mrs J O'Donoghue; Plantgrowers Australia Ltd

SECTION PSA

CLYDESDALE CROSS SPORT HORSE

NORTH ARENA RING NO. 8a
 Judged: **Saturday to follow on after Clydesdales**
 Judge: **tba**
(Information page 32)

- > Proudly supported by Clydesdale Cross Sport Horse Association
 > All horses must be registered with CCSHA and current financial members

- 362 Best Presented Clydesdale Cross Sport Horse
 363 Led Male
 364 Led Female
 365 **Champion & Res Champion Led Clydesdale Cross Sport Horse**
 366 Ridden Male
 367 Ridden Female
 368 **Champion & Res. Champion Ridden Clydesdale Cross Sport Horse**

SECTION QSA

LIGHT HARNESS

NORTH ARENA RING NO. 8B
 Judged: Saturday at 12 Noon
 Judge: Dianne Kee
(Information page 32)

- > Sashes kindly sponsored by the Harness Horse Society of Victoria

- 369 Viceroy Turnout, Horse or Pony
 370 Buggy or Jinker Turnout, Horse or Pony
 371 **Champion & Reserve Champion Turnout**
 372 Novice Horse or Pony driven
 373 Miniature driven in harness
 374 Shetland driven in harness
 375 **Champion & Res. Champion Miniature or Shetland**
 (winners from above two classes eligible)
 376 Pony 11.2hh & under (excluding Shetlands & Miniatures)
 377 Pony over 11.2hh and not exceeding 14hh
 378 Harness Horse over 14 hands
 379 Hackney or part Hackney Horse or Pony
 380 **Champion & Reserve Champion Harness Horse or Pony**
 (winner from above four classes eligible)

Trophy awarded to Champion:

THE MRS. JOHN GRICE MEMORIAL PERPETUAL HARNESS PONY TROPHY
\$100 CASH PRIZE & PERSONAL TROPHY TO KEEP
"IN MEMORY OF ANNE GRICE...SHE LOVED THE HARNESS PONIES" DONATED BY
APPALOOSAS AND AUSTRALIAN SPOTTED PONIES INC.

- 381 **Supreme Champion Harness Exhibit**
 (All Champions eligible)
 382 Open Whip 18 years & over
 383 Open Whip under 18 years
 384 Multiple Turnout, Horses and Ponies

SUNDAY PROGRAM

SECTION ASU

SMARTEST ON PARADE, RIDING & NEWCOMER PONIES & HORSES

SOUTH ARENA RING NO.1

Judged: Sunday at 8.30am
Judge: Erin Mitchell
(Information page 32)

- 1 Miniature Turnout under 12.2hh, rider 8 years & under
- 2 Smartest on Parade, 8 years and under 12 years
- 3 Smartest on Parade, 12 years and under 16 years
- 4 Smartest on Parade, 16 years and under 18 years
- 5 Smartest on Parade, 18 years and under 21 years
- 6 Smartest on Parade, 21 years and over
- 7 Rider under 8 years – Winner receives \$25 Tack Box voucher
- 8 Rider 8 years and under 10 years- Winner receives \$25 Tack Box voucher
- 9 Rider 10 years and under 12 years- Winner receives \$25 Tack Box voucher
- 10 **Champion & Reserve Rider Under 12 Years**
Champion receives \$100 cash kindly donated by Rotary Club of Dandenong
- 11 Rider 12 years and under 14 years- Winner receives \$25 Tack Box voucher
- 12 Rider 14 years and under 16 years- Winner receives \$25 Tack Box voucher
- 13 **Champion & Reserve Rider 12 Years & Under 16 Years**
Champion receives \$100 cash kindly donated by Rotary Club of Dandenong
- 14 Rider 16 years and under 18 years- Winner receives \$25 Tack Box voucher
- 15 Rider 18 years and under 21 years- Winner receives \$25 Tack Box voucher
- 16 Rider 21 years and over- Winner receives \$25 Tack Box voucher
- 17 **Champion & Reserve Rider 16 Years & Over**
Champion receives \$100 cash kindly donated by Rotary Club of Dandenong
- 18 Good Hands for Boys & Girls (Certificate provided)
Good Hands Competition to be run in accordance with the rules and regulations of Victorian Agricultural Shows Ltd
- 19 Newcomer Pony not over 12hh
- 20 Newcomer Pony over 12hh and not over 13hh
- 21 Newcomer Pony over 13hh and not over 14hh
- 22 **Champion & Reserve Newcomer Pony**
- 23 Newcomer Galloway over 14hh and not over 14.2hh
- 24 Newcomer Galloway over 14.2hh and not over 15hh
- 25 **Champion & Reserve Newcomer Galloway**
- 26 Newcomer Hack over 15hh and not over 15.2hh
- 27 Newcomer Hack over 15.2hh and not over 16hh
- 28 Newcomer Hack over 16hh and not over 16.2hh
- 29 **Champion & Reserve Newcomer Hack**
- 30 "OFF THE TRACK" COMPETITION. To be exhibited in accordance with Qualifiers Regulations and sponsored by 'Racing Victoria' **\$50, sash, card and Racing Victoria Prize Pack**. For conditions of entry and information relating to this event and the Final please refer to "www.racingvictoria.net.au/offthetrack/default.aspx" on the internet



**OFF THE
TRACK**
THOROUGHBRED

RACING VICTORIA

SOUTH ARENA RING NO. 1

Judged: Sunday at 10.00 am

Judge: Ruby Cristoph
(Information page 32)

- > Sponsored by Riding Pony Stud Book Society Inc.
 > All ponies must be registered Riding Ponies and owners must be current financial members of the Riding Pony Stud Book Society Inc. Ponies must be shown in the registered owners name Registration Certificates and Membership cards must be produced upon request. Failure to do so will lead to disqualification from the class. Ridden ponies must be 3 years and over. Newcomer Ridden Ponies are now eligible to compete in the Lead Rein, First Ridden, Ridden Show Pony & Ridden Show Hunter Pony classes (Newcomer cards still required if competing in Newcomer classes).

- 31 Lead Rein Pony–n.e.12hh, Rider 3 yrs & under 8 yrs on day of show
 32 First Ridden Pony – n.e. 12.2hh, Rider under 12 yrs on day of show
 33 **Mini Champion & Res. Champion Childs Pony**
 Stallions are INELIGIBLE for the above classes
 34 Senior Led Show Pony 4 yrs & over, over 13.2hh & n.e. 14.2hh
 35 Senior Led Show Pony 4 yrs & over, over 12.2hh & n.e. 13.2hh
 36 Senior Led Show Pony 4 yrs & over, n.e. 12.2hh
 37 **Champion & Reserve Champion Senior Led Show Pony**
 38 Colt, Gelding or Filly 2 yrs ne 12hh OR 3 yrs ne 12.1hh
 39 Colt, Gelding or Filly 2 yrs over 12hh & ne 13hh OR 3 yrs over 12.1hh & ne 13.1hh
 40 Colt, Gelding or Filly 2 yrs over 13hh & ne 14hh OR 3 yrs over 13.1hh & ne 14.1hh
 41 Colt, Gelding or Filly yearling ne 13.3hh
 42 **Junior Champion & Reserve Junior Champion Youngstock**
 43 **SUPREME CHAMPION LED SHOW PONY EXHIBIT** (from Senior Champion & Youngstock Champion) Sash provided by **RIDING PONY STUD BOOK SOCIETY INC. – Equinade Product**
 44 RPSBS Led Youngstock Male or Female 3 yrs & under, to mature over 14.2hh (not eligible for supreme led)
 45 RPSBS Led Male or Female over 3 yrs., 14.2hh & over(not eligible for supreme led)
 46 **Champion & Reserve Champion Led RPSBS (not eligible for supreme)**
 47 Senior Led Show Hunter 4 yrs & over, over 13.2hh & n.e. 14.2hh
 48 Senior Led Show Hunter 4 yrs & over, over 12.2hh & n.e. 13.2hh
 49 Senior Led Show Hunter 4 yrs & over, n.e. 12.2hh
 50 **Champion & Reserve Champion Led Show Hunter**
 Ponies entered in above classes are INELIGIBLE for Senior Led Show Pony classes
 Newcomer cards MUST be produced
 51 Newcomer Ridden Pony n.e. 12.2hh
 52 Newcomer Ridden Pony over 12.2hh & n.e. 13.2hh
 53 Newcomer Ridden Pony over 13.2hh & n.e. 14.2hh
 54 **Champion & Reserve Champion Newcomer Ridden Pony**
 Stallions are INELIGIBLE for Newcomer classes
 55 Ridden Show Pony n.e. 12.2hh
 56 Ridden Show Pony over 12.2hh & n.e. 13.2hh
 57 Ridden Show Pony over 13.2hh & n.e. 14.2hh
 58 **Champion & Reserve Champion Ridden Show Pony**
 Ponies entered in above classes are INELIGIBLE for newcomer ridden & ridden show pony classes

**SHOWING VICTORIA****2016 SADDLE HORSE CHAMPIONSHIPS**

Prince of Wales Showgrounds, Bendigo

FRIDAY 8TH & SATURDAY 9TH JANUARY 2016**ENTRIES CLOSE FRIDAY, 27TH NOVEMBER, 2015**

FOR ENQUIRIES CONTACT: VAS LTD OFFICE

PHONE: 03 5441 5555

EMAIL: info@vicagshows.com.auWEB: www.vicagshows.com.au

- 59 Ridden Show Hunter Pony n.e. 12.2hh
 60 Ridden Show Hunter Pony over 12.2hh & n.e. 13.2hh
 61 Ridden Show Hunter Pony over 13.2hh & n.e. 14.2hh
 62 **Champion & Reserve Champion Ridden Show Hunter Pony**
 Ponies entered in above classes are INELIGIBLE for newcomer & ridden show pony classes
 63 Ridden RPSBS 14.2hh & under 15hh
 64 Ridden RPSBS 15hh & over
 65 **Champion & Reserve Champion Ridden RPSBS**

SECTION CSHSU

SADDLE HORSE CHAMPIONSHIP

SOUTH ARENA RINGS NO.2 & 3
 Judged: Sunday from 8.30am
 Judge: Judges from rings 2 & 3
 ENTRY FEE: \$10.00 pre-entry & \$15.00 on the day
 (Information page 32)

> Prizes in each class

Champion Sash & Rug donated in memory of Tex Grentell by his family. Runner Up Sash and prize donated by EFO Equestrian Fashion Outlet (www.efoequestrianfashionoutlet.com.au)

66 **SHOW HORSE** Open to Hack, Galloway or Pony
 Judged: Sunday from 8.30am
 Workout for Show Horse:
 *Diagram of workout will be available at horse secretary's office on South Arena on the day and on our website: www.dandyshow.com.au

67 **SHOW HUNTER HORSE** Open to Hack, Galloway or Pony
 Judged: Sunday not before 9.00am
 Workout for Show Hunter Horse:
 *Diagram of workout will be available at horse secretary's office on South Arena on the day and on our website: www.dandyshow.com.au

Rings No. 2 & 3 are to start normal classes after the judging of the above Saddle Horse Championships

EDDY BATUR INDUSTRIAL PAINTING PTY LTD

65 Bayview Road, Hastings 3195
 0418 336 926 / 5979 2667



KWA BUILDING PERMITS & INSPECTIONS PTY LTD

356 Main Road, Mornington 3931
 1300 592 737 / info@kwabuildingpermits.com.au



FREEDOM FM FACILITIES MANAGEMENT

4 Hi Tech Place, Seaford 3198
 9785 3833 / 0409 165 941



SOUTH ARENA RING NO.2

Judged: Sunday after 10.00am

Judge: Sherrie Lee

(Information page 32)

- 68 **Best Presented Pony**
 69 Led Pony not over 10.2hh
 70 Led Pony over 10.2hh and not over 12hh
 71 Led Pony over 12hh and not over 14hh
 72 **Champion & Reserve Champion Led Pony**
 73 Novice Pony not over 12.2hh
 74 Ridden Shetland
 75 Open Pony not over 11.2hh
 76 Open Pony over 11.2hh and not over 12hh
 77 Open Pony over 12hh and not over 12.2hh
 78 **Champion & Res. Champion Pony 12.2hh & Under**
 79 Novice Pony over 12.2hh and not over 14hh
 80 Open Pony over 12.2hh and not over 13hh
 81 Open Pony over 13hh and not over 13.2hh
 82 Open Pony over 13.2hh and not over 14hh
 83 **Champion & Res. Champion Pony Over 12.2hh & Not Over 14hh**
 84 Open Galloway over 14hh and not over 14.2hh
 85 Open Galloway over 14.2hh and not over 15hh
 86 **Champion & Reserve Champion Galloway**
 87 Open Hack over 15hh and not over 15.2hh
 88 Open Hack over 15.2hh and not over 16hh
 89 Open Hack over 16hh and not over 16.2hh
 90 Open Hack over 16.2hh
 91 **Champion & Reserve Champion Hack**
 92 Show Hunter Pony 12hh and under
 93 Show Hunter Pony over 12hh and not over 13hh
 94 Show Hunter Pony over 13hh and not over 14hh
 95 **Champion & Reserve Champion Show Hunter Pony**
 96 Show Hunter Galloway over 14hh and not over 14.2hh
 97 Show Hunter Galloway over 14.2hh and not over 15hh
 98 **Champion & Reserve Champion Show Hunter Galloway**
 99 Show Hunter Hack over 15hh and not over 15.2hh
 100 Show Hunter Hack 15.2hh and not over 16hh
 101 Show Hunter Hack 16hh and not over 16.2hh
 102 Show Hunter Hack over 16.2hh
 103 **Champion & Reserve Champion Show Hunter Hack**

PAGE BROS CARAVANS

48 Wells Road, Seaford 3198
 9786 1000 / pagebros.com.au



GUTHRIE & ASSOCIATES
LAWYERS

Heather J Guthrie, BEc LLB
 70 Station Street, Somerville 3912
 5977 6054
 guthrieandassoc@ozemail.com.au

LAWYERS

SECTION DSU

OPEN/SHOW HUNTER GALLOWAY, HACK, PONY

SOUTH ARENA RING NO.3

Judged: Sunday after 10.00am

Judge: Tamara Lee

(Information page 32)

- 104 **Best Presented Galloway**
- 105 Led Galloway over 14hh and not over 14.2hh
- 106 Led Galloway over 14.2hh and not over 15hh
- 107 **Champion & Reserve Champion Led Galloway**
- 108 Novice Galloway over 14hh and not over 15hh
- 109 Open Galloway over 14hh and not over 14.2hh
- 110 Open Galloway over 14.2hh and not over 15hh
- 111 **Champion & Reserve Champion Galloway**
- 112 Open Hack over 15hh and not over 15.2hh
- 113 Open Hack over 15.2hh and not over 16hh
- 114 Open Hack over 16hh and not over 16.2hh
- 115 Open Hack over 16.2hh
- 116 **Champion & Reserve Champion Hack**
- 117 Ridden Shetland
- 118 Open Pony not over 11.2hh
- 119 Open Pony over 11.2hh and not over 12hh
- 120 Open Pony over 12hh and not over 12.2hh
- 121 **Champion & Reserve Champion Pony 12.2hh & Under**
- 122 Open Pony over 12.2hh and not over 13hh
- 123 Open Pony over 13hh and not over 13.2hh
- 124 Open Pony over 13.2hh and not over 14hh
- 125 **Champion & Res. Champion Pony Over 12.2hh & Not Over 14hh**
- 126 Show Hunter Galloway over 14hh and not over 14.2hh
- 127 Show Hunter Galloway over 14.2hh and not over 15hh
- 128 **Champion & Reserve Champion Show Hunter Galloway**
- 129 Show Hunter Hack over 15hh and not over 15.2hh
- 130 Show Hunter Hack 15.2hh and not over 16hh
- 131 Show Hunter Hack 16hh and not over 16.2hh
- 132 Show Hunter Hack over 16.2hh
- 133 **Champion & Reserve Champion Show Hunter Hack**
- 134 Show Hunter Pony 12hh and under
- 135 Show Hunter Pony over 12hh and not over 13hh
- 136 Show Hunter Pony over 13hh and not over 14hh
- 137 **Champion & Reserve Champion Show Hunter Pony**

SECTION ESU

STANDARD BRED PLEASURE & PERFORMANCE

SOUTH ARENA RING 4

Judged: Sunday at 8.30am

Judge: Sammy Kilgour

(Information page 32)

- > *Indicates that Partbreds (registered with the SPPHAV) are eligible to enter these events.
- > Proof of membership with the SPPHAV (copy of current membership card) must be provided by all contestants in this ring. If pre-entering, please provide a photocopy with your entries. SPPHAV committee members will verify memberships on the day. Ring 0427 004 821 for membership.
- Horses can be competed in Foundation and gender height classes OR Novice and gender height classes, but not all 3.
- > Placings gained at this show count towards the SPPHAV Annual HRV High Point Award and the National High Point Competition.

- 138 *Best Presented Male. (Stallion or gelding)
- 139 *Best Presented Female
- 140 *Novice Led Horse
- 141 *Led partbred male

NORTON GATES

03 5979 1053

nortongates.com.au



- 142 *Led partbred female
 143 **Champion & Reserve Champion Partbred**
 144 Led Male – entire/gelding 15.2hh & under
 145 Led Male – entire/gelding over 15.2hh
 146 **Champion & Reserve Champion Male Standardbred**
 147 Led Female, 15.2 hands & under
 148 Led Female, over 15.2 hands
 149 **Champion & Reserve Champion Led Female**
 150 **SUPREME CHAMPION LED STANDARDBRED EXHIBIT – Equinade Product**
 151 *Smartest on Parade
 152 Foundation Ridden Standardbred - horse is unable to canter
 153 *Novice Ridden Standardbred – horse has some canter ability
 154 *Ridden Partbred Male
 155 *Ridden Partbred Female
 156 **Champion & Reserve Champion Ridden Partbred**
 157 Ridden Male – entire/gelding
 158 Ridden Female
 159 **Champion & Reserve Champion Ridden Standardbred**
 160 *Novice Rider
 161 *Rider, 19 years & under
 162 *Rider, over 19 years
 163 **Champion & Reserve Champion Rider**
 164 *Best Educated Standardbred.
 165 *Best Pleasure Standardbred (snaffle only, no whips or spurs)
 166 *Turnout Harness (any harness)
 167 Working Racing Harness
 168 *Working Non-Racing Harness
 169 **Champion & Reserve Champion Working Harness**

SPONSORED BY
**STANDARDBRED PLEASURE & PERFORMANCE
 HORSE ASSOCIATION OF VICTORIA INC.**

For further information about SPPHAV
 visit www.spphav.org.au or call 0427 004 821.
 (secretary@spphav.org.au)



SECTION FSU

OPEN/SHOW HUNTER HACK, PONY, GALLOWAY

SOUTH ARENA RING NO.4
 Judged: Sunday after 10.00am
 Judge: Rianna Percy
 (*Information page 32*)

- 170 **Best Presented Hack**
 171 Led Hack over 15hh and not over 16hh
 172 Led Hack over 16hh
 173 **Champion & Reserve Led Hack**
 174 Novice Hack over 15hh
 175 Open Hack over 15hh and not over 15.2hh
 176 Open Hack over 15.2hh and not over 16hh
 177 Open Hack over 16hh and not over 16.2hh
 178 Open Hack over 16.2hh
 179 **Champion & Reserve Champion Hack**
 180 Ridden Shetland
 181 Open Pony not over 11.2hh
 182 Open Pony over 11.2hh and not over 12hh
 183 Open Pony over 12hh and not over 12.2hh
 184 **Champion & Reserve Champion Pony 12.2hh & Under**
 185 Open Pony over 12.2hh and not over 13hh
 186 Open Pony over 13hh and not over 13.2hh
 187 Open Pony over 13.2hh and not over 14hh
 188 **Champion & Res. Champion Pony Over 12.2hh & Not Over 14hh**
 189 Open Galloway over 14hh and not over 14.2hh
 190 Open Galloway over 14.2hh and not over 15hh
 191 **Champion & Reserve Champion Galloway**
 192 Show Hunter Hack over 15hh and not over 15.2hh
 193 Show Hunter Hack 15.2hh and not over 16hh
 194 Show Hunter Hack 16hh and not over 16.2hh
 195 Show Hunter Hack over 16.2hh
 196 **Champion & Reserve Champion Show Hunter Hack**
 197 Show Hunter Pony 12hh and under
 198 Show Hunter Pony over 12hh and not over 13hh
 199 Show Hunter Pony over 13hh and not over 14hh
 200 **Champion & Reserve Champion Show Hunter Pony**
 201 Show Hunter Galloway over 14hh and not over 14.2hh
 202 Show Hunter Galloway over 14.2hh & and not over 15hh
 203 **Champion & Reserve Champion Show Hunter Galloway**

SECTION GSU

PINTO

VIC CHANDLER HIGH POINT SHOW- Pintos to be registered with Victorian Pinto Society and owners must be financial members of the Victorian Pinto Society.

SOUTH ARENA Ring No. 5

Judged: Sunday 9am

Judge: Ashlea Gell
(Information page 32)

- 204 Best Presented Pinto
205 Junior Handler, under 12 years
206 Junior Handler, 12 years – 14 years
207 Led Stallion or Colt, 10.2 hands & under, 4 years & over
208 Led Colt, 10.2 hands & under, 3 years & under
209 Led Mare, 10.2 hands & under, 4 years & over
210 Led Filly, 10.2 hands & under, 3 years & under
211 Led Gelding, 10.2 hands & under, 4 years & over
212 Led Gelding, 10.2 hands & under, 3 years & under
213 **Champion & Reserve Champion 10.2hh & Under**
214 Led Yearling Colt, Filly or Gelding, over 10.2 hands
215 Led Colt, 2 & 3 years, over 10.2 hands
216 Led Filly, 2 & 3 years, over 10.2 hands
217 Led Gelding, 2 & 3 years, over 10.2 hands
218 Junior Champion & Reserve Junior Champion Pinto
219 Led Stallion, over 10.2 & not over 14hh, 4 years & over
220 Led Stallion, over 14 hands, 4 years & over
221 **Champion & Reserve Champion Pinto Stallion**
222 Led Mare, over 10.2 & not over 14hh, 4 years & over
223 Led Mare, over 14 hands, 4 years & over
224 **Champion & Reserve Champion Pinto Mare**
225 Led Gelding, over 10.2 & not over 14hh, 4 yrs & over
226 Led Gelding, over 14 hands, 4 years & over
227 **Champion & Reserve Champion Pinto Gelding**
228 **SUPREME CHAMPION LED PINTO – Equinade Product**
229 Ridden Pinto, 14hh & over
230 Ridden Pinto, under 14hh & over 10.2hh
231 Ridden Pinto, 10.2hh & under
232 **Champion & Reserve Champion Ridden Pinto**
233 Costume Class

SPONSORED BY
THE VICTORIAN PINTO SOCIETY



SECTION HSU

PALOMINO

SOUTH ARENA RING NO. 5

Judged: Sunday 11am (following Pinto)

Judge: Ashlea Gell
(Information page 32)

- > All horses competing in these classes must be registered with a recognised colour breed Society.

APHA DOUBLE POINT SHOW

LED CLASSES

- 234 Best Presented Palomino
235 Best Body Colour
236 Best Mane & Tail
237 Stallion, 4 years & over
238 Colt, 3 years and under
239 **Champion and Reserve Champion Led Stallion or Colt – Champion receives \$15**
240 Mare 4 years and over
241 Filly, 3 years and under
242 **Champion and Reserve Champion Led Mare or Filly – Champion receives \$15**
243 Gelding, any age 14.2hh and over
244 Gelding, any age under 14.2hh
245 **Champion & Reserve Champion Led Gelding – Champion receives \$15**
246 **SUPREME CHAMPION LED PALOMINO receives \$30 plus Equinade Product**

RIDDEN EVENTS

- 247 Stallion or Colt
248 Gelding
249 **Champion & Reserve Ridden Palomino – Champion receives \$25**

SPONSORED BY
APHA AUSTRALIAN PALOMINO HORSE BREEDERS ASSOCIATION INC.
DANDENONG PROMOTIONAL GROUP

SOUTH ARENA RING NO.5

Judged: Sunday – not before 1pm to follow on after Palomino

Section

Judge: Ashlea Gell
(Information page 32)

> All entries in this section must be registered with NBS and exhibitors must be financial members.

Note: 10.2h and under only eligible to compete in either height or age/sex class.

LED CLASSES

- 250 Best Presented Buckskin
 251 10.2h and under
 252 Stallion 4 years & over
 253 Colt 3 years & under
 254 **Champion & Reserve Led Entire**
 255 Mare 4 years & over
 256 Filly, 3 years & under
 257 **Champion & Reserve Led Female**
 258 Gelding 4 years & over
 259 Gelding 3 years & under
 260 **Champion & Reserve Champion Led Gelding**
 261 **Supreme Champion Led Buckskin- Equinade Product**

RIDDEN CLASSES

- 262 Ridden 10.2h and under
 263 Ridden Stallion or Colt
 264 Ridden Mare or Filly
 265 Ridden Gelding
 266 **Champion & Reserve Champion Ridden Buckskin Section B & C**
 267 Best Presented Section B & C
 268 Led Male
 269 Led Female
 270 **Champion & Reserve Led Section B & C**
 271 Ridden Section B & C

**WESTERNPORT TRACTORS
 AND IMPLEMENTS PTY LTD**
**JOHN DEERE****STIHL®**

Ross Beischer
 1863 Frankston-Flinders Road, Hastings 3915
 5979 2155 / 0414 397 736
 sales@westernporttractors.com.au

FARM MACHINERY

SOUTH ARENA Ring No.6
 Judged: Sunday - 9.00am
 Judge: Wendy McDonald
(Information page 32)

Pure Arabians to be registered with the Arabian Horse Society of Australia and Derivatives to be registered in Anglo & Part Bred Section of Stud Book. Registration numbers must be entered on the entry forms.

272 Best Presented (open to all Purebreds, Derivatives and Ponies)

LED CLASSES

Arabian Stock Horse, Anglo Arabians, Arabian Warmbloods, Quarab and Partbred Arabian (Arabian Ponies and registered Arabian Riding Ponies not eligible in this section – see below).

- 273 Colt 3 years and under
- 274 Stallion 4 years and over
- 275 Filly yearling
- 276 Filly 2 and 3 years old
- 277 Mare 4 years and over
- 278 Gelding 3 years and under
- 279 Gelding 4 years and over
- 280 Arabian Derivative mare/gelding shown by a youth under 18 years
- 281 **Champion and Reserve Champion Arabian Derivative**

ARABIAN RIDING PONIES

- 282 Colt, 3 years and under
- 283 Filly, 3 years and under
- 284 Mare, 4 years and over
- 285 Stallion, 4 years and over
- 286 Gelding any age
- 287 Arabian Riding Pony mare/gelding shown by a youth under 18 years
- 288 **Champion and Reserve Champion Arabian Riding Pony**

ARABIAN PONIES

- 289 Filly, 3 years and under
- 290 Colt, 3 years and under
- 291 Mare, 4 years and over
- 292 Stallion, 4 years and over
- 293 Gelding any age
- 294 Arabian Ponies mare/gelding shown by youth under 18 years
- 295 **Champion and Reserve Champion Arabian Pony**
- 296 **SUPREME CHAMPION ARABIAN DERIVATIVE, RIDING PONY OR ARABIAN PONY – Equinade Product & Garland donated by R & S Coldebella**

PURE BRED ARABIAN

- 297 Filly, yearling
- 298 Filly, 2 & 3 years
- 299 Mare (dry), 4 years & over
- 300 **Champion & Reserve Champion Pure Arabian Female**
- 301 Colt 3 years & under
- 302 Stallion, 4 years and over
- 303 Gelding any age.
- 304 Arabian Purebred mare/gelding to be shown by youth under 18 years
- 305 **Champion & Reserve Champion Pure Arabian Male**
- 306 **SUPREME CHAMPION LED PURE ARABIAN EXHIBIT – Equinade Product Garland donated by: R & S Coldebella.**

RIDDEN CLASSES

- 307 Ridden Pure Bred
- 308 Ridden Arabian Derivative Stallion or Colt
- 309 Ridden Arabian Derivative Filly, Mare or Gelding not over 14 hands
- 310 Ridden Arabian Derivative Filly, Mare or Gelding over 14 hands
- 311 Arabian/Arabian Derivative/Ponies to be ridden by youth under 14 years
- 312 Arabian/Arabian Derivative/Ponies to be ridden by youth 14 years & under 18 years
- 313 Arabian/Arabian Derivative/Ponies Show Hunter under 14.2hh
- 314 Arabian/Arabian Derivative/Ponies Show Hunter over 14.2hh
- 315 Arabian/Arabian Derivative/Ponies Bridle path hack under 14.2hh
- 316 Arabian/Arabian Derivative/Ponies Bridle path hack over 14.2hh
- 317 **Champion & Reserve Champion Ridden Arabian/Derivative**
- 318 Costume Class, Arab Dress, Stallions permitted (open to Pure Bred & Derivatives)

This section proudly sponsored by V.A.H.A.

SECTION KSU

OPEN COLOURED

SOUTH ARENA RING NO. 6

Judged: Sunday – not before 1.00pm to follow on after Arabs & Derivatives

Judge: Wendy McDonald
(Information page 32)

> Open to all coloured Pinto, Paint, Spotted, Buckskin, Palomino, Perlino and White - registered or not.

- 319 Best Presented Open Coloured
- 320 Led Stallion/Colt, 10.2 hands & under
- 321 Led Stallion/Colt, 10.2 hands to 12hh
- 322 Led Stallion/Colt, 12hh to 14hh
- 323 Led Stallion/Colt, over 14 hands
- 324 **Champion & Reserve Champion Stallion/Colt**
- 325 Led Mare/Filly, 10.2 hands & under
- 326 Led Mare/Filly, 10.2 hands to 12hh
- 327 Led Mare/Filly, 12hh to 14hh
- 328 Led Mare/Filly, over 14 hands
- 339 **Champion & Reserve Champion Mare/Filly**
- 330 Led Gelding, 10.2 hands & under
- 331 Led Gelding, 10.2 hands to 12hh
- 332 Led Gelding, 12hh to 14hh
- 333 Led Gelding, over 14 hands
- 334 **Champion & Reserve Champion Gelding**
- 335 Ridden, 10.2 hands & under
- 336 Ridden, 10.2 hands to 12hh
- 337 Ridden, 12hh to 14hh.
- 338 Ridden, over 14 hands
- 339 **Champion & Reserve Champion Ridden Exhibit**
- 340 Costume Class, under 14 hands
- 341 Costume Class, over 14 hands

SECTION LSU

SPORTING HORSE

MAIN ARENA RING NO. 8

Judged: Sunday Novice 10am/Open 1pm

Judge: Simon Karp
(Information page 32)

STRICTLY – NO LATE ENTRIES

NOVICE EVENTS:

Entry Fee: \$3.00 per event
Judged: Sunday 10am – Main Arena

- Ribbons all events
- All novice events will be run strictly to Sporting Horse Rules
- Sport Horse Members to wear Uniform
- Non Members to wear White Shirt & Jodhpurs
- Hard Hats must be worn in all events
- All entries must state the Horse Name on the entry form or the entry will not be accepted.

- 1 Bending Race, under 11 years
- 2 Bending Race, open novice
- 3 Stake Race, under 11 years
- 4 Stake Race, open novice
- 5 Flag & Barrel Race, under 11 years (3 flags)
- 6 Flag & Barrel Race, open novice
- 7 Lead Race, under 11 years
- 8 Barrel Race, open novice

SPORTING HORSE EVENTS
SPONSORED BY
EQUINADE PRODUCTS
MANUFACTURERS OF
QUALITY HORSE PRODUCTS



OPEN EVENTS:

Entry Fees: Under 15 years events – \$4.00 unless noted otherwise

Under 18 years – \$5.00 unless noted otherwise

Open Events – \$6.00 unless noted otherwise

Judged: Sunday 1pm – Main Arena

- Sporting Horse Members to Wear Uniform
 - Non Members to wear White Shirt & Jodhpurs
 - Hard hats must be worn in all Sporting Horse Events
 - All entries must state the Horse Name on the entry form or the entry will not be accepted.
 - All events are to run in accordance with the Sporting Horse Australia Rules & Regulations
-

9 Bending Race, under 15 years. 1st \$20; 2nd \$15; 3rd \$5; 4th \$3

10 Bending Race, under 18 years. 1st \$20; 2nd \$15; 3rd \$5; 4th \$3

11 **Bending Race, Open. 1st \$60; 2nd \$25; 3rd \$15; 4th \$5**

Open Bending Race proudly Sponsored by “Blast Masters”

12 Flag & Barrel Race, under 15 years. 1st \$20; 2nd \$15; 3rd \$5;

13 Flag & Barrel Race, under 18 years. 1st \$20; 2nd \$15; 3rd \$5;

14 Stake Race, under 15 years. 1st \$20; 2nd \$15; 3rd \$5; 4th \$3

15 Stake Race, under 18 years. 1st \$20; 2nd \$15; 3rd \$5; 4th \$3

16 Stake Race, Open: 1st \$55, 2nd \$24, 3rd \$15, 4th \$5

Flag & Barrel and Stake Races proudly Sponsored by “Blast Masters”

17 Barrel Race, Open: 1st \$100; 2nd \$40; 3rd \$20; 4th \$10

Barrel Race Open proudly sponsored by Prime Pak

18 Medley B. Lead-Bend-Flag: 1st \$100; 2nd \$40; 3rd \$20

Medley B. is proudly sponsored by “Dulux Australia”

19 **FEATURE EVENT**

The Alf Follett Memorial Flag & Barrel Race

Entry Fee \$10.00

Prize Money: 1st \$150.00 plus Society Sash

2nd \$60 & Sash; 3rd \$25 & Sash

Proudly sponsored by: **John Follett and Bev & Ron Girling.**

Champion Under 15 years Novelty Pony – \$25 Voucher & NBSash

Champion Under 18 years Novelty Pony – \$25 Voucher & Sash

Champion Open Novelty Pony – \$50 Voucher & Sash

Combination Championship overall Champion Horse” from the “Dandenong & Ballarat Agricultural Shows” – Horse Rug proudly sponsored by Sporting Horse Australia

**VOUCHERS FOR CHAMPION NOVELTY PONIES & SASHES
DONATED IN MEMORY OF BRIAN GRAHAM BY HIS FAMILY**